

1643 Avex

Large flange head · Aluminium body · Stainless steel stem · Multi-grip
4.8 mm (3/16")

Features

- Multi-grip capability accommodates wide variations in material thickness
- Good hole fill provides strong, vibration resistant joints
- Compensates for irregular, oversized, slotted or misaligned holes
- Can stop sheet movement in non-standard holes
- Retained stem avoids damage, electrical problems or rattling caused by loose stems
- Provides a large blind side bearing area against the rear sheet
- Spreads the tail bearing load/clamp load on the rear sheet making it ideal for use in thin sheet materials

Material

- Body: Aluminium alloy (2.5% Mg) AA5052, natural
- Stem: Stainless steel, natural

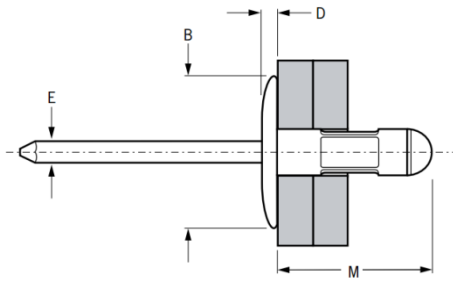

Before Placement

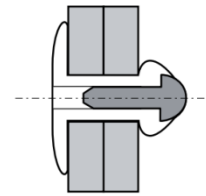

After Placement

Part No.	Size Ø	Grip Range		Hole Size		M max.	øB max.	D max.	øE max.	Shear (typical) kN	Tension (typical) kN
		min.	max.	min.	max.						
01643-00613	4.8 (3/16")	1.6	6.3	4.9	5.0	13.6	16.2	2.2	2.9	1.4	2.0
01643-00621		6.4	12.7			19.7				1.2	
01643-00631		12.7	19.8			27.6				1.3	



Can't find what you are looking for?

We can provide customized finishing and colouring.
Contact your nearest [Gripwell](#) team for assistance!